

# HE2XINH

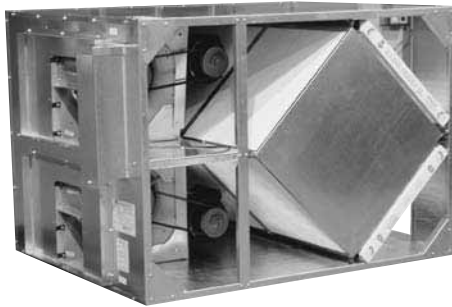

## Indoor Unit



## Specifications

Ventilation Type: Static Plate, Heat and Humidity Transfer						
Typical Airflow Range: 500-2,000 CFM						
AHRI 1060 Certified Core: Two L125-00						
Airflow Rating Points (for AHRI): 1,500 CFM and 1,120 CFM						
Number Motors: Direct Drive (DD) Four, Belt Drive (BD) Two						
Drive HP	Volts	HZ	Phase	FLA	Min. Cir. Amps	Max. Fuse Size
DD 0.75	115	60	Single	8.6	36.6	45
	208-230	60	Single	4.3	18.3	20
	277	60	Single	2.4	10.2	15
	208-230 460	60 60	Three Three	2.1 1.1	9.8 4.9	15 15
BD 1.5	208-230	60	Single	9.3-9.0	20.9	30
	208-230	60	Three	4.8-4.8	10.8	15
	460	60	Three	2.4	5.4	15
	575	60	Three	1.8	4.1	15
BD 2	208-230	60	Single	11.3-10.5	25.4	35
	208-230	60	Three	6.2-6.2	14.0	20
	460	60	Three	3.1	7.0	15
	575	60	Three	2.3	5.2	15
Control Voltage: 24 VAC						
Filters: Four total, MERV 8, 2" pleated, 20" x 20" nominal size						
Weight: 414 lbs (unit), 420 lbs (shipping weight)						
Shipping Dimensions: 50" W x 62" L x 41" H						

## G5 Performance

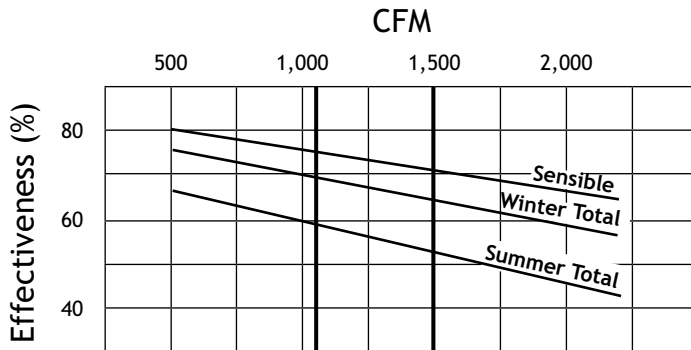

\*At AHRI 1060 standard conditions  
(See certified data on page 67 for core components.)

## Airflow Performance

Motor HP	Blower RPM Nominal	Turns Open	External Static Pressure (Inches Water Column)													
			0.0		0.25		0.5		0.75		1.0		1.25		1.5	
			CFM	BHP	CFM	BHP	CFM	BHP	CFM	BHP	CFM	BHP	CFM	BHP	CFM	BHP
0.75 (Four DD) Single Phase	N/A	N/A	1,950	0.5	1,830	0.5	1,670	0.4	1,400	0.4	1,150	0.4	700	-	-	-
	N/A	N/A	2,240	0.9	2,155	0.9	2,020	0.8	1,795	0.7	1,490	0.7	1,190	0.6	-	-
0.75 (Four DD) Three Phase	N/A	N/A	1,960	0.5	1,840	0.5	1,700	0.4	1,600	0.4	1,380	0.4	1,190	0.4	800	0.4
	N/A	N/A	2,500	0.9	2,300	0.9	2,125	0.8	1,900	0.7	1,700	0.7	1,500	0.6	1,260	0.6
1.5 (BD)	1,000	4.5	1,378	0.5	1,175	0.5	900	0.4	635	0.4	-	-	-	-	-	-
	1,230	2	1,694	0.9	1,550	0.9	1,335	0.8	1,125	0.7	1,000	0.7	500	0.6	-	-
	1,420	0	1,956	1.4	1,850	1.4	1,680	1.2	1,475	1.2	1,300	1.1	1,200	1.1	930	0.9
2 (BD)	1,220	4.5	1,681	0.9	1,530	0.9	1,315	0.7	1,100	0.7	975	0.6	-	-	-	-
	1,470	2	2,025	1.6	1,925	1.5	1,750	1.4	1,575	1.3	1,375	1.2	1,275	1.2	1,125	1.1
	1,660	0	-	-	-	-	2,000	2.0	1,900	1.9	1,750	1.8	1,570	1.7	1,475	1.7

Note: Brake Horse Power (BHP) is for one blower motor package only.

# HE2XINH UNIT DIMENSIONS

- EA: Exhaust Air to outdoors
- OA: Outdoor Air Intake
- RA: Room Air to be exhausted
- FA: Fresh Air to inside

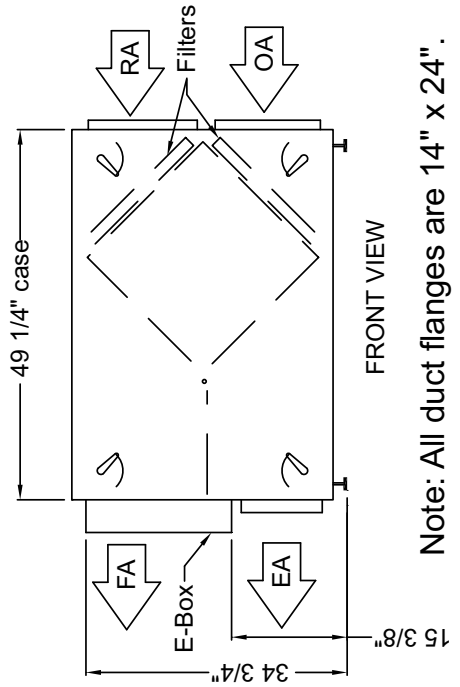
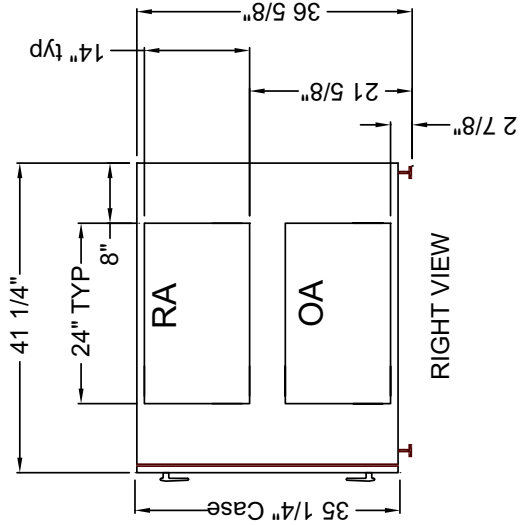
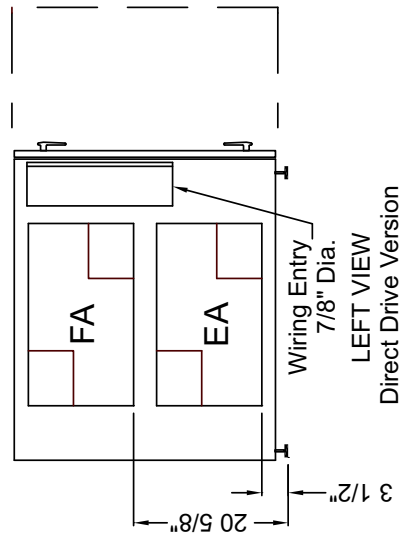
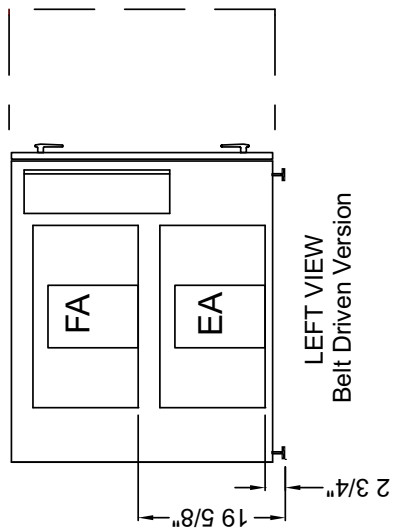
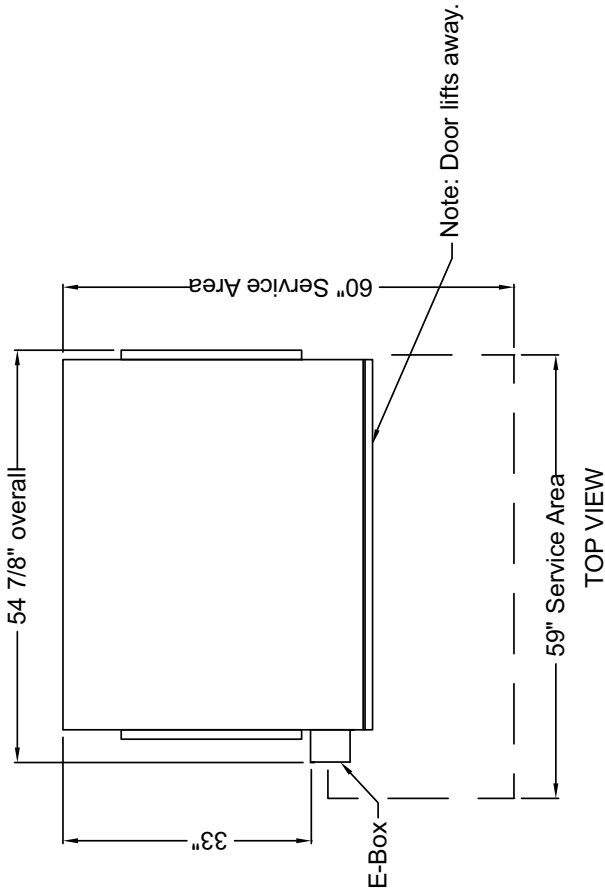

Note: All duct flanges are 14" x 24".